

1. Gleichmäßige Wandstärke

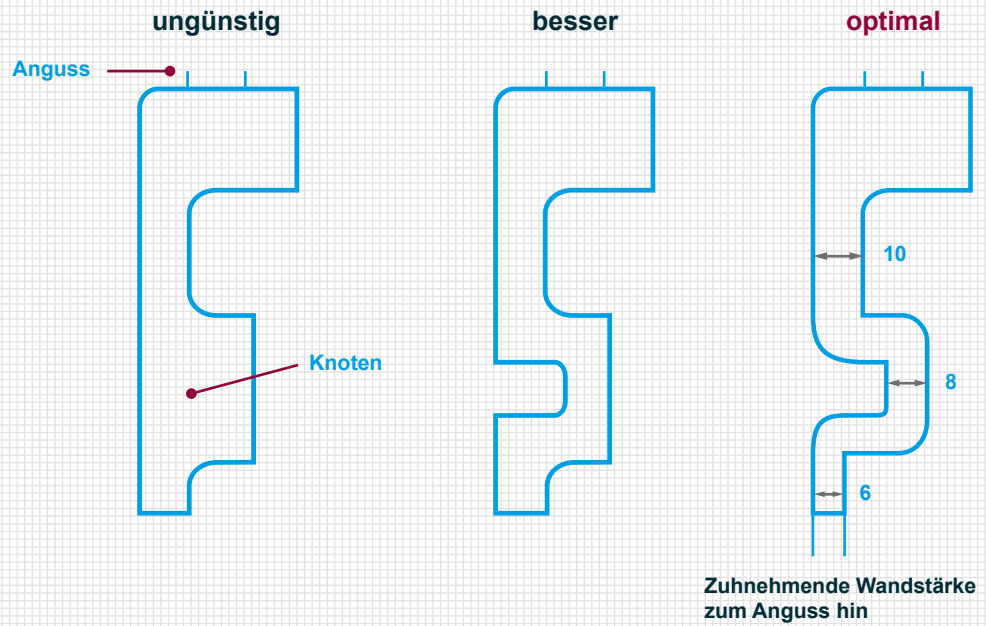

2. Kanten verrunden

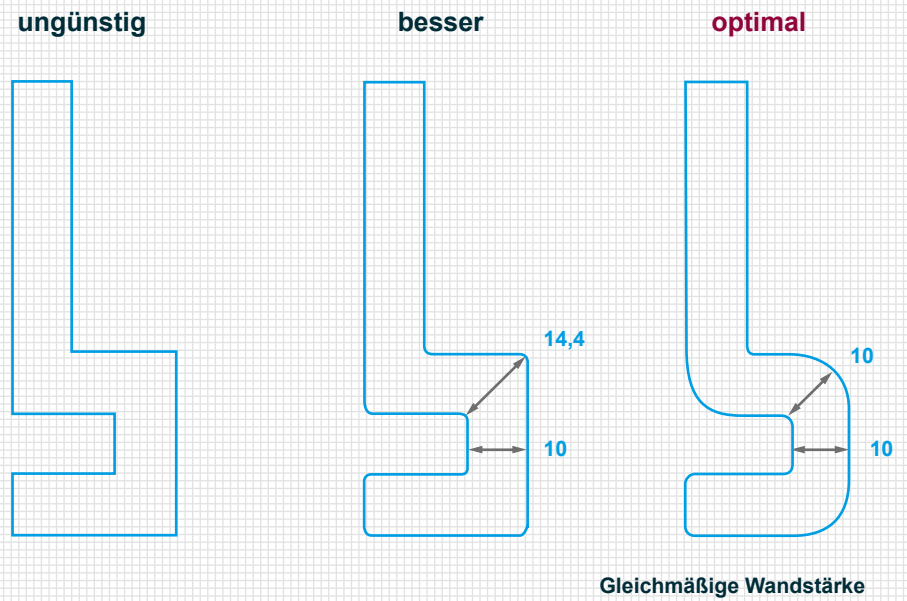

3. Formschrägen im Innenbereich

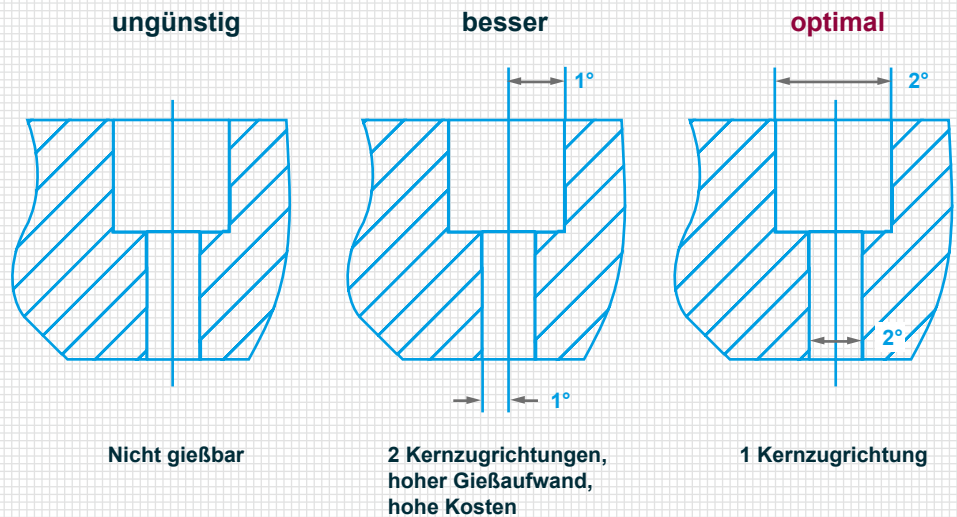

4. Entformbarkeit

ungünstig

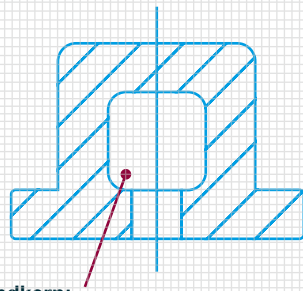

besser

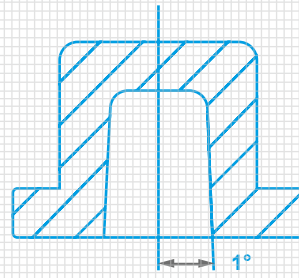

optimal

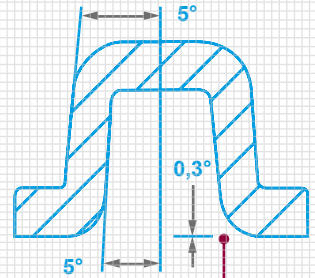

Sandkern:

- hohe Werkzeugkosten
- nur bei Messing & Alu möglich
- gleichmäßige Wandstärke einhalten

5. Spitze Kanten

ungünstig

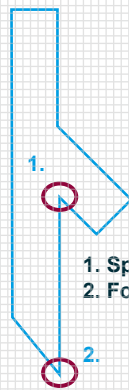

1. Spitze nicht gießbar
2. Form erhitzt sich

besser

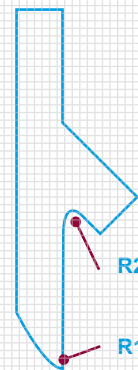

optimal

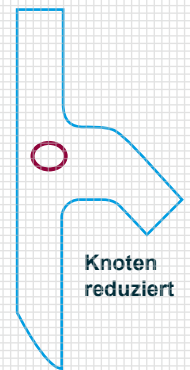

6. Materialanhäufung

ungünstig

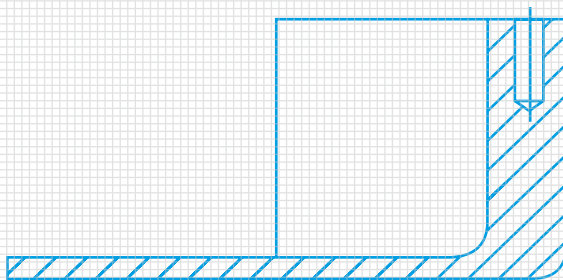

optimal

Materialanhäufung auflösen

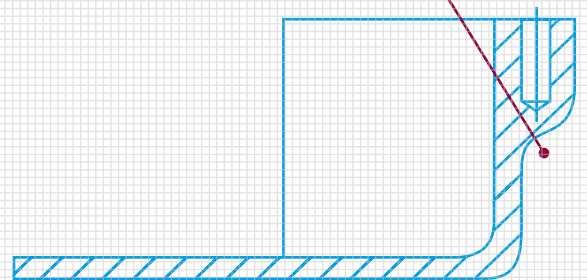

7. Kreuzverrippung

ungünstig

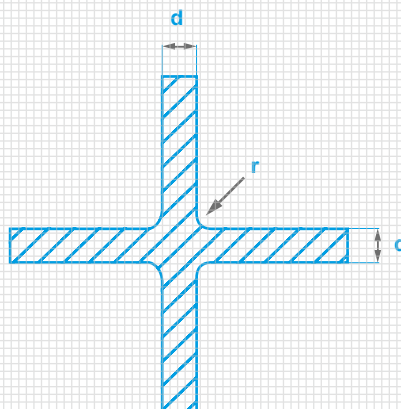

optimal

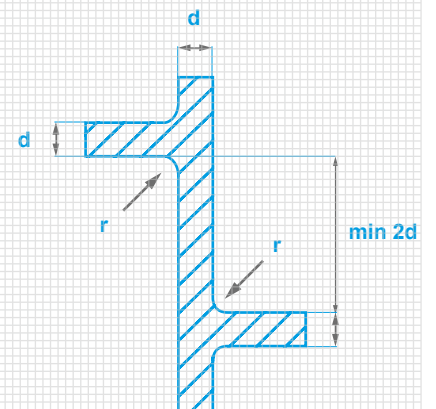

Kreuzverrippung auflösen